



Adapter Sub-D 9 pin male > female 270° angled

Description

This serial adapter by Delock enables you to angle the female port of your serial device by 270°. Thus you can connect your serial cable without any problem in case the existing serial female port is difficult to access.



| | |
|-----------------------|---------------|
| Ref. | 65267 |
| EAN | 4043619652679 |
| Country of origin | China |
| Customs tariff number | 84718000 |

Images

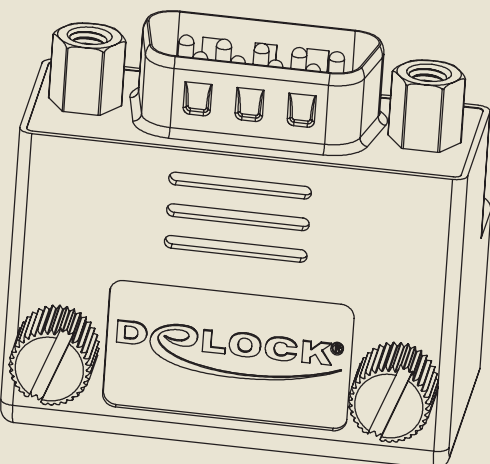
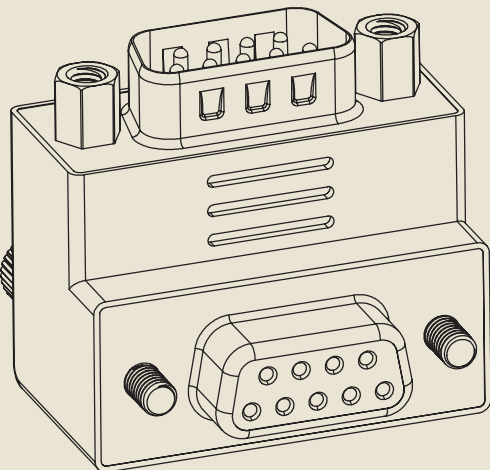

Specification

- Connector: Sub-D 9 pin male > Sub-D 9 pin female
- Female port 270° angled
- Sub-D 9 female with screws
- Sub-D 9 male with screw nuts

Package content

- Adapter Sub-D 9 pin

Package

- Delock poly bag